

8' Park Bench with Back
 In-Ground or Portable/Surface Mount with Perforated Steel Planks
 - Specifications -

Rev.: 30Apr15

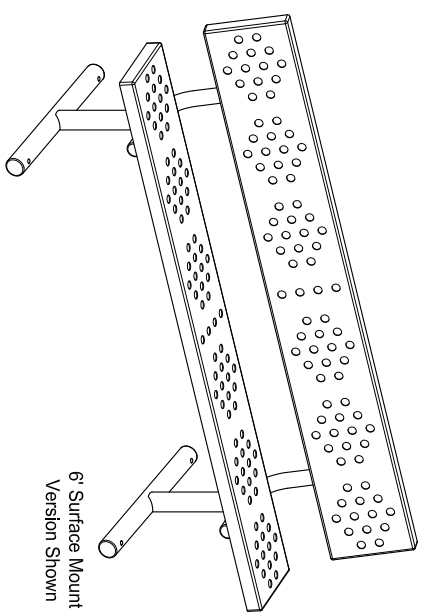

In-Ground
 Leg Style

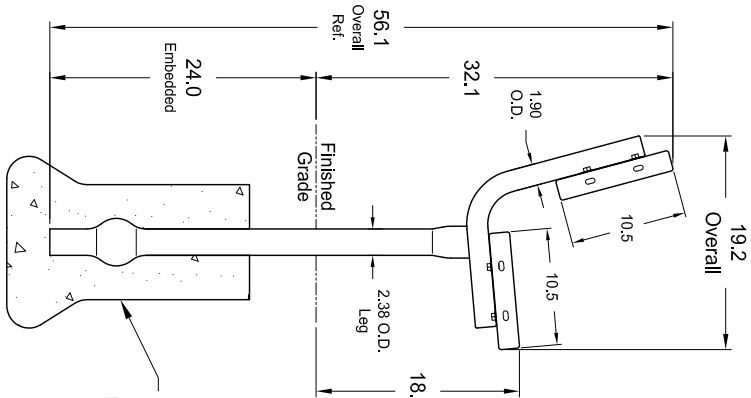

Portable/Surface Mount
 Leg Style

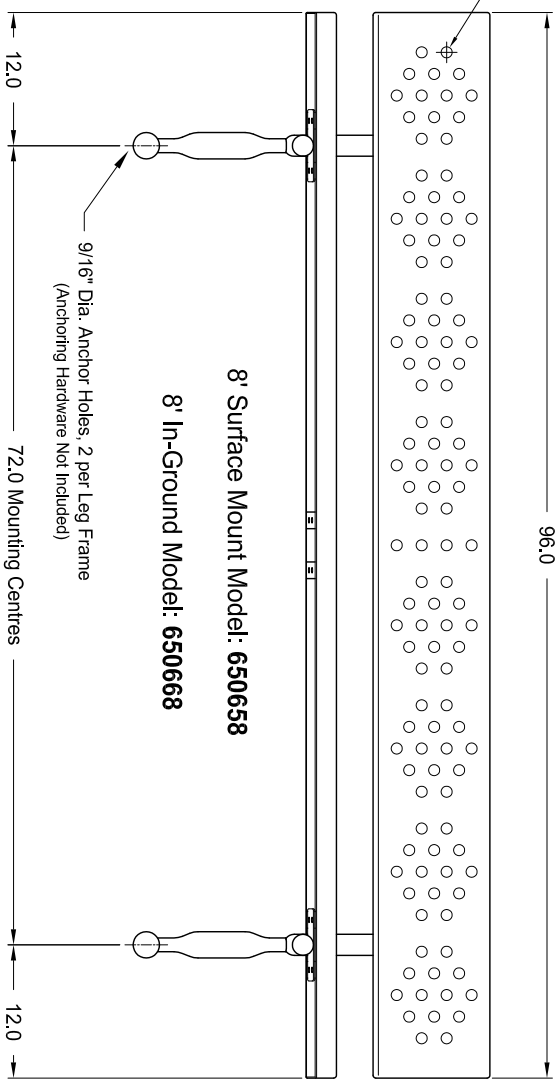
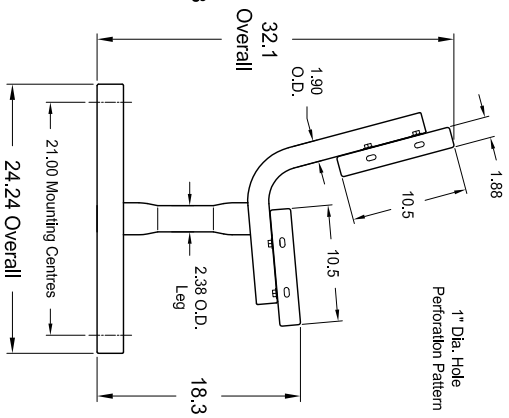

Typical Assembly Method

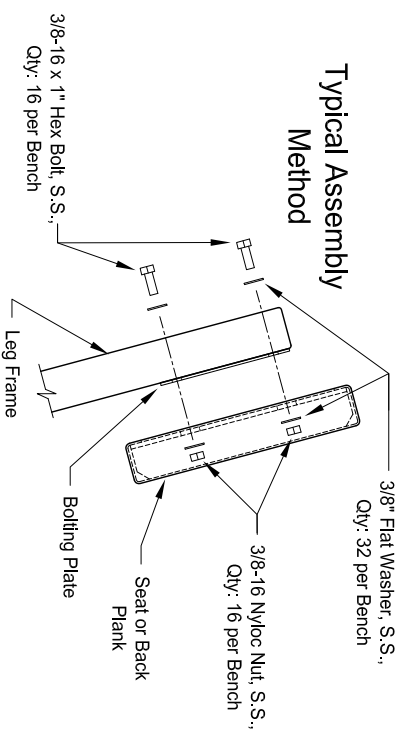

Materials:

- 2.375" O.D. x .125" Wall HSS Tube (Leg Tubes)
- 1.9" O.D. x .125" Wall HSS Tube (Seat Tubes)
- 11 Ga. Steel (Bolting Plates)
- 13 Ga. Perforated Steel (Seat & Backrest Planks)
- 7 Ga. Steel (Seat Brackets/Ribs)
- Stainless Steel Hardware
- Anchoring Hardware Not Included

Seat Plank Finish:

Polyester Powder Paint over Zinc Rich Primer.

Leg Frame Finishes:

- 1) Polyester Powder Paint over Zinc Rich Primer.
- 2) Hot Dip Galvanized

Notes:

Dimensions shown are in inches.

Knill Fabrication Ltd. maintains a policy of continuous product improvement.

As a result, some details may change without notice.

Concrete Footing
 by Others:
 Depth & diameter
 to suit local
 frost conditions.